

EN 14492-1
COMPLIANT



- High-strength, long-lasting steel body
- Extra reinforced planetary gear system by heat treatment made of special steel
- Lightweight and strong design
- Hydraulic disc brake system holding 100% load
- Front pulley and spring rope tensioner offered as standard
- Manual clutch as standard
- High torque hydromotor
- Corrosion and rust resistant electrostatic powder paint
- CE Machinery Directive 2006/42/EC
- Relevant standards EN 14492-1 : 2006 Standard for power-driven cranes

Max. Pulling Force kg/lbs	6.200 kg (13668 lbs)
Max. Rope Diameter (mm/in)	12 mm (1/2")
Max. Rope Length (m-ft)	53 m (173 ft)
Hydromotor(cc/in³)	315 cc (19 in³)
Max. Pump Flow (lt/min-g/min)	60 L (15.8 gal)
Gear Ratio	6 : 1
Max. working pressure (bar/psi)	158 bar (2291 psi)
Recommended Gear Oil	80 w 90 - 0.75 L
Product Weight	81 kg (178 lbs)

Rope Winding Number	Pulling Capacity (kg/lbs)	Rope Winding Speed (mt-min/ft-min)	Rope Length (m/ft)
1	6200/13668	10.6/34	7/22
2	5165/11386	11.8/38	14.7/48
3	4412/9726	13/42	23.1/75
4	3852/8492	14.3/46	32.4/106
5	3417/7533	15.5/50	42.4/138
6	3071/6770	16.7/54	53/173

Pulling Capacity kg/lb Rope Speed m/min-ft/min Rope Length m/ft

- Warning!!!
- The A-B lines must be open to the T-Tank line before the winch can be started.
- Hydromotor Drain line must be open
- The last 5 turns of rope should always be left on the winch.
- This winch is designed and manufactured for towing purposes, do not use for lifting people or materials!
- Kms Winch reserves the right to make changes in technical details.

Standard

- Roller Fairlead
- Cable Tensioner
- Manual Clutch

Hydraulic Inlets

- G 1/2"

Optional

- Air Clutch
- IP67 - IP 68
- Rope alligner guide system

Mounting Bolts

- 16 pieces M12 8.8K

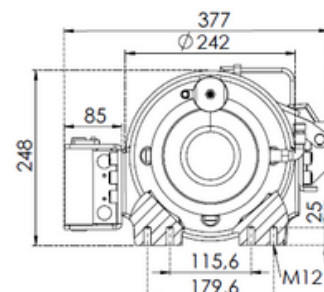
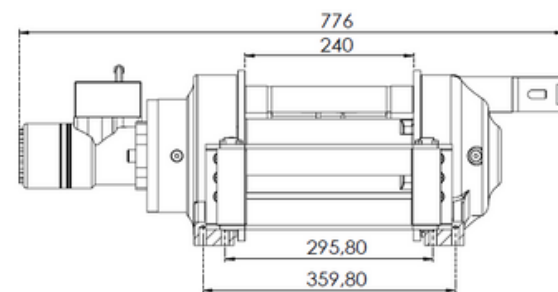
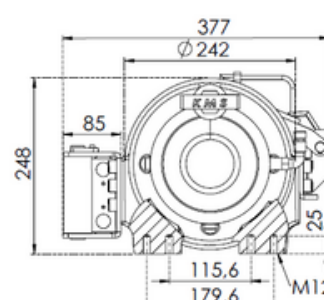
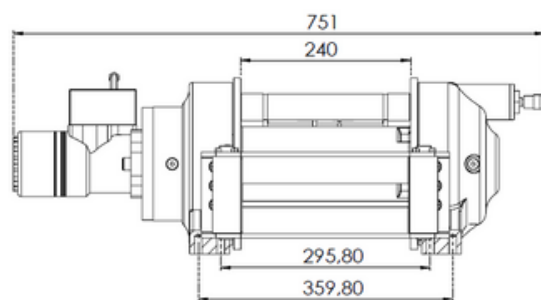

[Standard]
Manual Clutch



[Optional]
Air Clutch

